

OPERATION, MAINTENANCE, AND INSTALLATION MANUAL

FOR
VC-100 VERTICAL COMPACTION UNIT

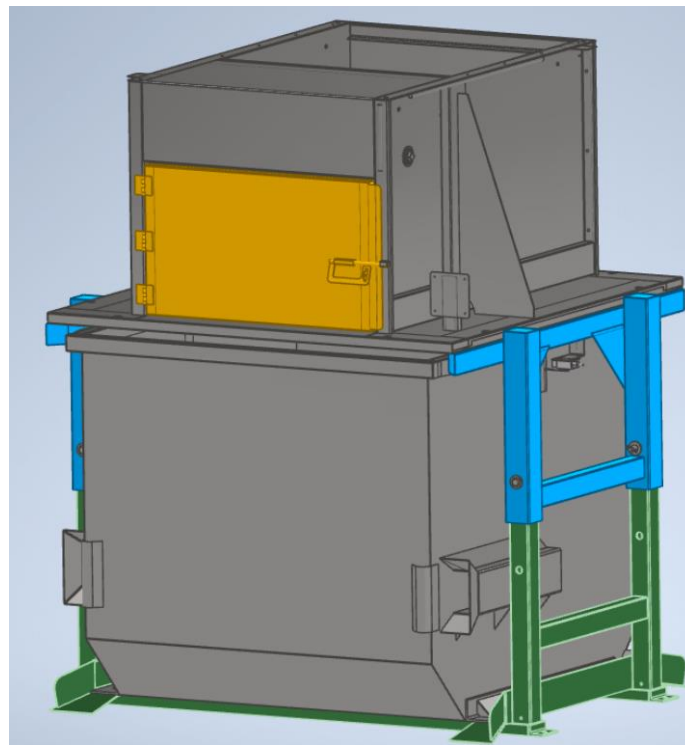

INTER  PAK

COMPACTION UNITS

MANUFACTURED BY: INTERNATIONAL CONTAINER CO., LLC
110 NORTH BRIDGE ST., HOLYOKE, MA 01040

TABLE OF CONTENTS

- 1- INTRODUCTION
- 2- GENERAL SPECIFICATIONS
- 3- CHARGE BOX SPECIFICATIONS
- 4/5- LOCK OUT/TAG OUT PROCEDURES
- 6- PREOPERATION INSTRUCTIONS
- 7- OPERATIONAL PENDANT DESCRIPTION
- 8- OPERATING INSTRUCTIONS
- 9- DECAL IMAGES
- 10- DECAL PART NUMBERS
- 11- DECAL PLACEMENT
- 12- PERIODIC MAINTAINENCE
- 13- CYLINDER REMOVAL INSTRUCTIONS
- 14/15- TROUBLESHOOTING
- 16/17- INSTALLTION
- 18/20- ELECTRICAL INSTALLATION
- 21- HYDRAULIC INSTALLATION
- 22- INSTALLATION START UP
- 23- HAULER INFORMATION
- 24- LEAGAL PROVISIONS

CAUTION: Review this manual before making the installation. Study the jobsite and the installation requirements carefully to be certain all necessary safeguards and/or safety devices are provided to protect all personnel and equipment during installation and as a complete system. Special attention is directed to the most current extract from American National Standards Institute Z245.2. These instructions are not intended as a substitute for proper training and experience in proper use and safety procedures in operating this equipment. International Container Co. does not assume responsibility for the installation procedures of this equipment. Conformance to local, state, and federal laws concerning installation rests with the customer.

THANK YOU FOR PURCHASING AN INTERNATIONAL CONTAINER VERTICAL COMPACTOR

This compactor is designed to give you reliable and superior performance for many years to come. The purpose of this manual is to provide the owner(s) and/or operator(s) with the necessary information to properly install, operate, and maintain your stationary compactor. This manual **IS NOT** intended as a primary training source, but as a reference guide for authorized, trained personnel. Each person involved in the operation, maintenance, and installation of the machine should read and thoroughly understand the instructions in this manual and follow **ALL** warnings prior to operation.

The owner(s) and/ or employer(s) involved in the operation, maintenance, and installation of this compactor should always read and understand the most current version of the following applicable standards:

ANSI-Z245.2

“STATIONARY COMPACTOR REQUIREMENTS”

A copy of this standard may be

obtained from: ANSI

25 West 43rd Street

New York, New York 10036

OSHA 29 CFR, Part 1910.147

“The control of hazardous energy (lockout/tagout)”

Employer(s)/Equipment owners are responsible for the safe installation, training, and operation of this equipment. Final installation requirements must be met by the installer. Employer(s)/Equipment owners are responsible for establishing and implementing a lock-out/tag-out procedure. This manual serves only as a guideline for these procedures.

Any service or repairs recommended by this manual should be performed by factory authorized personnel only.

If you need assistance with your compactor, please contact International Container Co., LLC. When contacting, you will need to provide the compactor serial number, installation date, and power unit serial number.

If you have any safety concerns with the equipment, or need further information, please contact us at:

INTERNATIONAL CONTAINER CO., LLC

110 N. Bridge St., Holyoke, MA 01040

413-538-9200

office@internationalcontainerco.com

In addition to this operation, maintenance, installation manual, an additional instructional manual is provided with each power unit. Please read all comprehensive instructions and information in both manuals prior to operation, maintenance, or installation. THIS MACHINE IS INHERENTLY DANGEROUS AND FAILURE TO FOLLOW THE INSTRUCTIONS CONTAINED IN THESE MANUALS MAY RESULT IN SERIOUS INJURY OR DEATH!



WARNING

IF INCORRECTLY USED, THIS EQUIPMENT CAN CAUSE SEVERE INJURY. THOSE WHO USE AND MAINTAIN THE EQUIPMENT SHOULD BE TRAINED IN ITS PROPER USE, WARNED OF ITS DANGERS, AND SHOULD READ AND FULLY UNDERSTAND THIS ENTIRE MANUAL BEFORE ATTEMPTING TO SET UP, OPERATE, ADJUST OR SERVICE THE EQUIPMENT. KEEP THIS MANUAL FOR FUTURE REFERENCE

2

GENERAL SPECIFICATION

VC-100 WITH 6 YARD CONTAINER

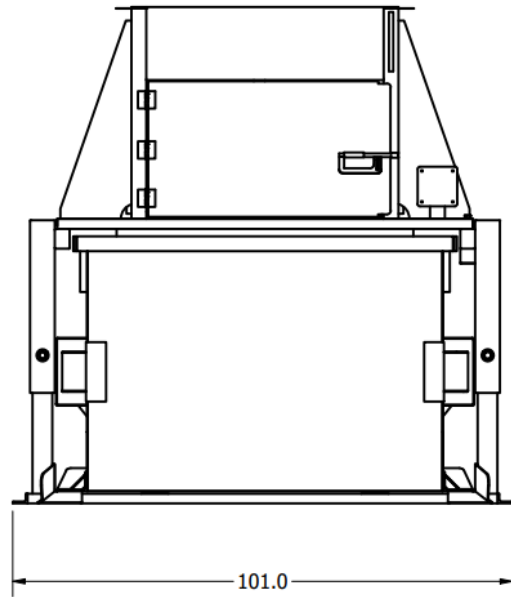
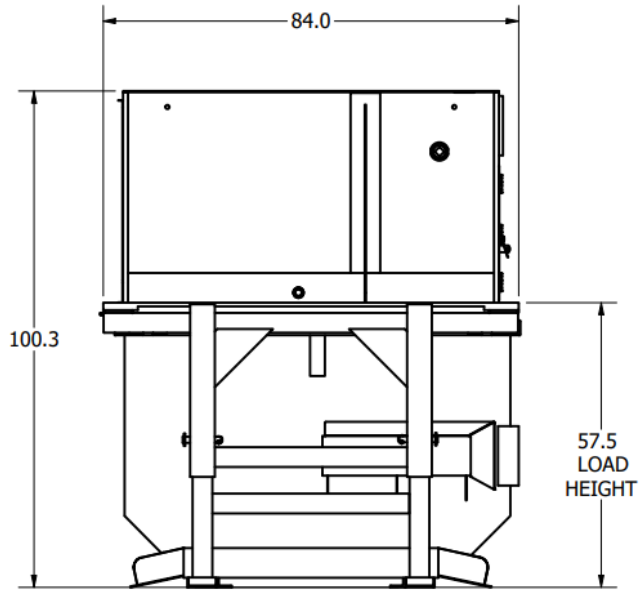

VC-100 WITH 8 YARD CONTAINER

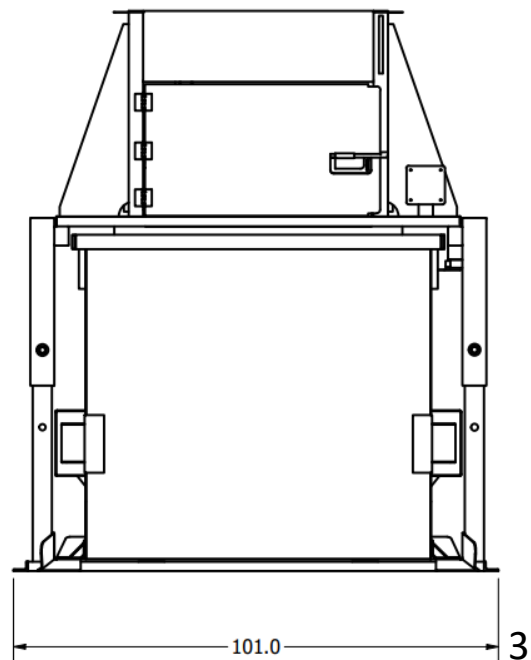
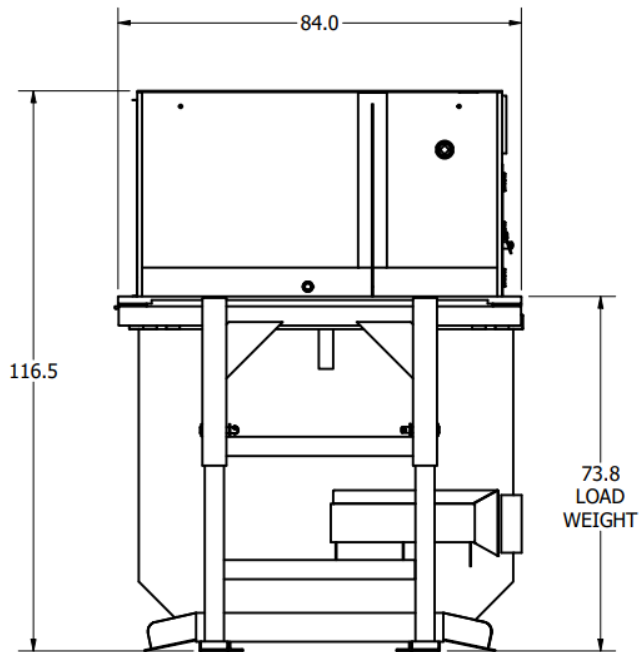

3

CHARGE BOX SPECIFICATIONS

VC-100

-DOOR OPENING-	28" X 48"
-*CYCLE TIME(SEC)-	20
-*RELIEF PRESSURE:	2000 PSI
-*100% FULL:	1800 PSI
- MOTOR HP:	5
-*PUMP CAPACITY(GPM):	5.2
-*RESERVOIR CAPACITY(GAL):	15
- HYDRAULIC CYLINDER:	
BORE:	4"
ROD:	2"
STROKE:	16"
-RAM PENETRATION:	16"

*- Varies depending on power unit manufacturer, and model of power unit. Please consult the manual provided in power unit of this compactor.

NOTE: Cycle times may vary due to power unit size, manufacturer, voltage, etc. Actual cycle time settings must be adjusted at the time of installation. Please consult the manual provided in the power unit for details.

LOCK-OUT/TAG-OUT INSTRUCTIONS

Before entering any part of the compactor, be sure that all sources of energy have been shut off, all potential hazards have been eliminated, and the compactor is locked-out and tagged-out in accordance with OSHA and ANSI requirements.

The specific Lock-Out and Tag-Out instructions may vary from company to company (i.e. multiple locks may be required, or other machinery may need to be locked-out and tagged-out). The following instructions are provided as minimum guidelines.

INSTRUCTIONS

1. Notify all affected employees that servicing, or maintenance is required on the compactor and that the compactor must be shut down and locked-out to perform the servicing or maintenance.
2. Perform a hazard assessment.
 - a. The authorized employee shall refer to the company procedure to identify the type and magnitude of the energy that the compactor utilizes, shall understand the hazards of the energy, and shall know the methods to control the energy.
3. Wear proper personal protective equipment.
4. If compactor is operating, it must be shut down by the normal stopping procedure. If the ram is pressing against a load, move the ram rearward before shutting the compactor down.
5. De-activate the energy isolating device(s) so that compactor is isolated from the energy source(s).
 - a. Shut down all power sources.
 - b. Move the main disconnect lever to the OFF position.
6. Lock-out the energy isolating device(s) with assigned individual lock(s).
 - a. Padlock the disconnect lever with a keyed padlock and take the key with you.
 - b. Along with the padlock, place an appropriate, highly visible, warning tag on the disconnect lever. The tag should provide a warning such as:
"Danger: Do not operate equipment. Person working on equipment." or
"Warning: Do not energize without the permission of _____."
 - c. Place operating components in such a position so as not to be subject to possible free fall and/or install additional blocking devices to prevent this potential for any raised or elevated component.
7. Stored hydraulic energy must be removed from the compactor hydraulic circuit for complete Lock-Out and Tag-Out. Make sure that this energy has been relieved by manually depressing the solenoid valve pin located in the center of each coil end of the directional control valve.
8. After locking and tagging the compactor, ensure that the compactor is disconnected from the energy source by first checking that no personnel are exposed, then verify the isolation of the equipment by operating the push button or other normal operating control(s) or by testing to make certain the equipment will not operate. Try to start and operate the compactor (as outlined in the Operating Instructions) to make sure the Lock-Out and Tag-Out is effective. If the Lock-Out and Tag-Out is effective, remove the key from the key switch and take it with you.

5

LOCK-OUT/TAG-OUT INSTRUCTIONS (CONTINUED)

9. Before entering compactor perform hazard assessment for confined space requirements (hazardous fumes, dust, toxic material, or other hazards) per the OSHA confined space standard.

RESTORING SERVICE

When the servicing or maintenance is completed and the compactor is ready to return to normal operating condition, the following steps shall be taken:

1. Check the compactor and the immediate area around the compactor to ensure that nonessential items have been removed and that the compactor components, guards and covers are operationally intact.
2. Check the work area to ensure that all employees have been safely positioned or removed from any hazardous area.
3. Verify that the controls are in neutral.
4. Remove the lock-out devices and re-energize the compactor.

NOTICE:

The removal of some forms of blocking may require re-energizing of the compactor before safe removal.

5. Notify affected employees that the servicing or maintenance is completed, and the compactor is ready for use.
6. Reassess area to determine all hazards are protected.

ELECTRICAL: The motor control panel contains high voltage components. Only authorized personnel should be allowed inside the control panel. Authorized personnel should be allowed inside the control panel only after the compactor has been locked out.



HYDRAULIC: Stored hydraulic energy must be removed from the compactor hydraulic circuit for a complete lock-out/tag-out. Make sure that this energy is relieved by manually depressing the solenoid valve pin located in the center of each coil end on the directional control valve.

Please Note: Some valves may have more than one coil and some power units may have more than one valve. All stored hydraulic energy must be removed. Disconnect the hydraulic quick disconnects that lead from the power unit to the compactor.

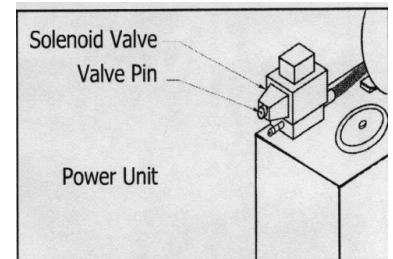

THE OWNER/EMPLOYER/OPERATOR IS RESPONSIBLE FOR HAVING A HAZARDOUS ENERGY CONTROL PROCEEDURE IN PLACE. THERE MAY ADDITIONAL LOCK-OUT/TAG-OUT PROCEDURES REQUIRED BEYOND THOSE LOCK-OUT/TAG-OUT PROCEDURES SET FORTH HEREIN.

PRE-OPERATION INSTRUCTIONS

Employers should allow only authorized and thoroughly trained personnel to operate this compactor.

This compactor is equipped with a key operated locking system. Keys should be in possession of only authorized personnel. Turn off and remove the key after use.

DANGER

ONLY TRAINED AND AUTHORIZED PERSONNEL SHOULD BE ALLOWED INSIDE PANEL BOX. The panel box contains high voltage components. See **Lock-Out/Tag-Out Instructions**.

WARNING

Do not operate compactor until operating instructions are thoroughly understood. Wear safety glasses and gloves when operating this equipment.

WARNING

Stay clear of all internal compactor parts and all moving external compactor parts when in operation. Failure to do so could result in serious personal injury or death!

WARNING

Never enter any part of compactor unless the disconnect switch has been turned off, padlocked, and all stored energy sources have been removed. See **Lock-Out/Tag-Out Instructions**.

WARNING

Do not remove access covers except for servicing. Only trained and authorized service personnel should be allowed to service this equipment. All access doors on the compactor body should always be secured in place when the unit is operating. See **Lock-Out/Tag-Out Instructions**.

WARNING

Before starting compactor, be sure no one is inside. Be certain that everyone is clear of all operation points and pinch point areas before starting.

WARNING

If the compactor is equipped with a security gate or doghouse with security door, be sure that the security gate or door is closed before the compactor is started.

NOTICE

Federal regulation prohibits the use of this equipment by anyone under 18 years of age.

OPERATIONAL CONTROL PENDANT DESCRIPTION

Typical control pendant. This may vary depending on the power unit manufacturer and model. This may vary from different power unit manufacturers. Please consult the manual provided in each power unit for specific details of your compactor operation.

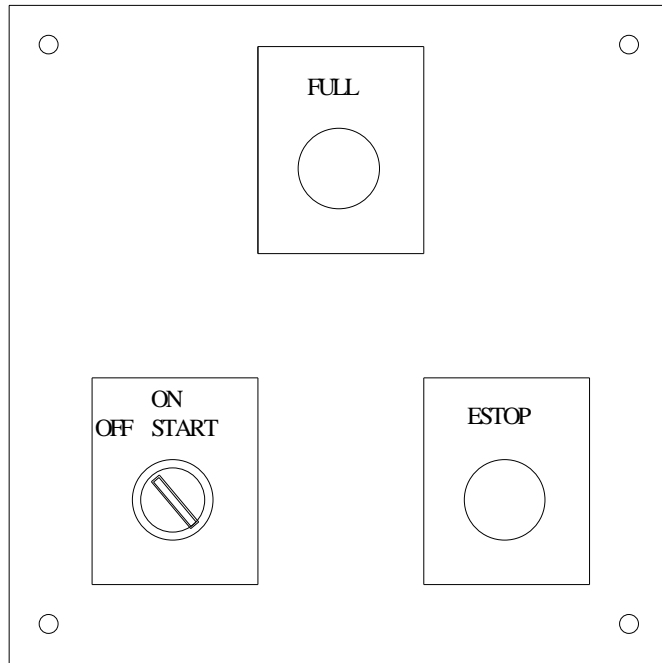

- 1) **KEYED HAND/ON/START SWITCH**- This Switch requires a key for operation. Insert Key in the OFF position and turn clockwise to START. The compaction ram will travel up and stop. At that time the feed door can be opened to load refuse. When the material is loaded, close the door. The material is automatically compacted, and the ram returns to mid-point. After use return the key to the OFF position and remove it.
- 2) **EMERGENCY STOP**- When depressed this mushroom head push button will stop ALL power operations of the compactor. Push this button to stop the machine in the event of an emergency or any time the machine needs to be stopped.
NOTE: Be thoroughly familiar with the location of each emergency stop button BEFORE operating the machine.
- 3) **FULL LIGHT**- This light will activate when the unit is full indicating it is time to empty the container.

OPERATING INSTRUCTIONS

Operation of compactor by trained and authorized personnel only! These operating instructions are not intended as a substitute for training and experience in proper use and safety procedures or protocols in operating this equipment. Do not operate compactor until operating instructions are thoroughly understood.

After the compactor has been properly installed with all safety equipment follow these instructions for proper start up before use.

- 1) Insert the key into the **OFF/ON/START** switch. Rotate the key clockwise to START. The compactor ram will retract to its UP position unlocking the feed door and stops.
- 2) Open the feed door and place material to be discarded into the compactor.
- 3) Close the feed door. The ram automatically cycles down and compacts the refuse. The ram then returns to the mid-point position and stops.
- 4) Repeat steps 1-3 as necessary after the compactor has stopped.
- 5) When you have finished using the compactor, remove the key from the key switch.
- 6) When the **FULL** light comes on, it is time for the hauler to empty the container.

IN CASE OF EMERGENCY PUSH THE LARGE RED BUTTON TO STOP!!!

Tips For Maximum Compaction

- Place refuse uniformly across the compaction area.
- ALWAYS keep the feed door closed. This assures the ram has fully compacted the refuse and has returned to the mid-point.

DECAL IMAGES



ICCLBL1000



CWL1000



SCC-001



SCC-002



SCC-003



SCC-004



SCC-005



SCC-006



SCC-007



SCC-008



SCC-011



SCC-012



SCC-013



SCC-014



SCC-015

DECAL PART NUMBERS

DECAL PART NUMBERS

When your compactor leaves the factory several WARNING DECALS are installed for your protection. These labels are subject to wear due to the nature of the operation. THE FOLLOWING DECALS MUST BE MAINTAINED. Additional decals maybe purchased through INTERNATIONAL CONTAINER CO. by calling 413-538-9200. When ordering replacement decals, match the part numbers in the chart below to the drawings on the previous page.

PART NUMBER	DESCRIPTION
ICCLBL	INTERNATIONAL CONTAINER CO.
CWL1000	WARNING/ CAUTION
SCC-001	WARNING STAND CLEAR OF COMPACTOR
SCC-002	CONFINED SPACE
SCC-003	WARNING DO NOT REMOVE ACCESS COVERS
SCC-004	DO NOT REMOVE CONTAINER UNTIL REAR STOPS...
SCC-005	CAUTION WIPE OFF SEAL AFTER DUMPING
SCC-006	NOTICE FEDERAL REGULATION<NO 18 YEARS OLD
SCC-007	FIRE HOSE PORT
SCC-008	DANGER HAZARDOUS VOLTAGE
SCC-011	DANGER VOLTS
SCC-012	CAUTION DISCONNECT HOSES
SCC-013	WARNING KEEP OUT CRUSH/SHEAR HAZARD
SCC-014	WARNING CRUSH/SHEAR CLOSE GATE
SCC-015	CAUTION COMPACTOR STARTS AUTOMATICALLY

**QUANTITIES VARY DEPENDING ON EQUIPMENT AND OPTIONS.
SOME DECALS MAY BE INSTALLED ON THE POWER UNIT**

DECAL PLACEMENT ON COMPACTOR

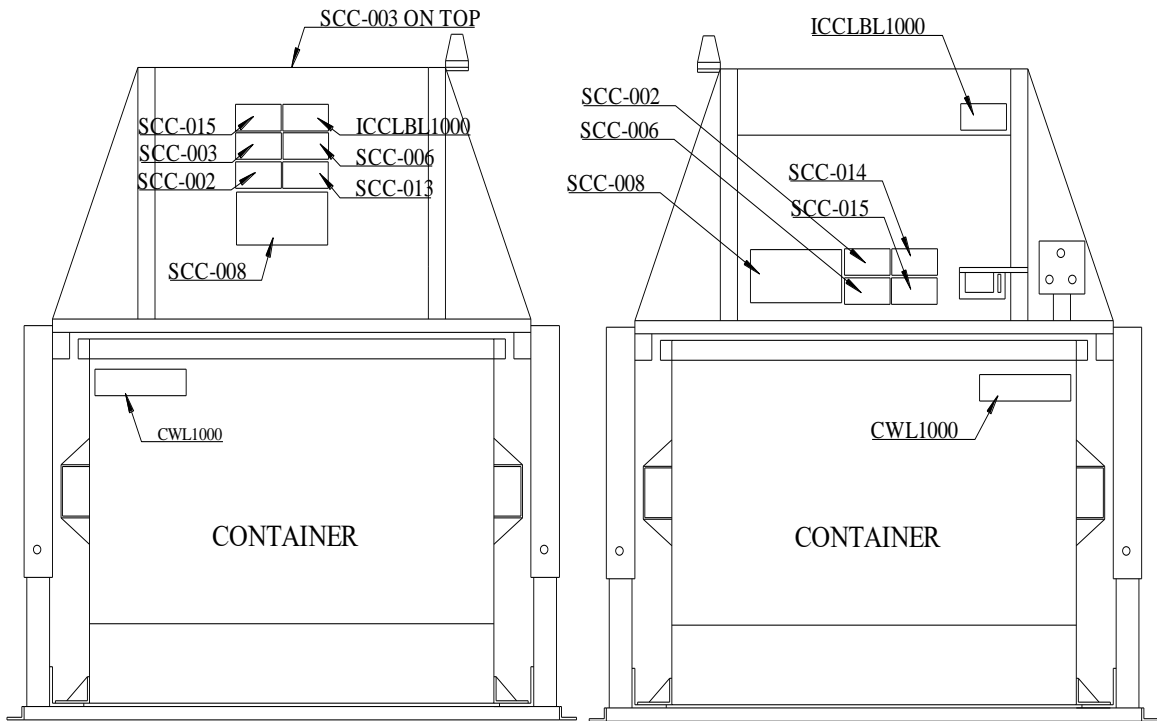

REAR VIEW

FRONT VIEW

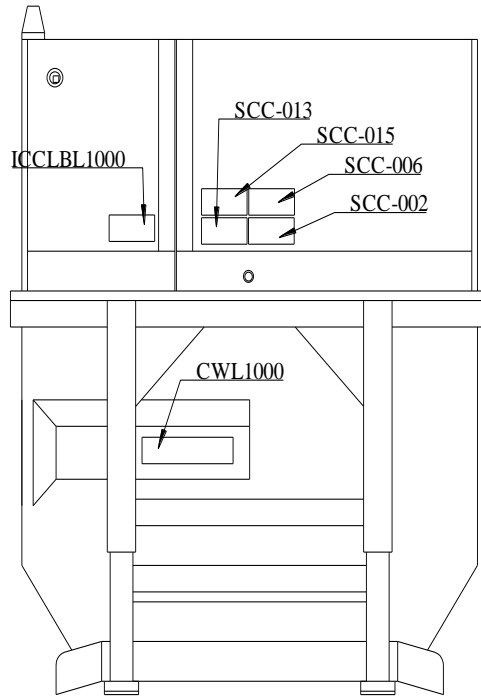

SIDE VIEW

PERIODIC MAINTAINANCE

DANGER: Only authorized and trained personnel should preform the following procedures. Lock out and tag-out the compactor as specified in the lock-out/tag-out instructions on pages 4 and 5. **DO NOT** enter the compactor for any reason until it has been locked out and tagged out per the Lock-Out/ Tag-Out instructions on pages 4 and 5. **WARNING: RAM SPEED ACCELERATES AS THE RAM RE-TRACTS!! NEVER ENTER ANY PART OF THE COMPACTOR OR CONTAINER UNTIL THE UNIT HAS BEEN LOCKED OUT AND TAGGED-OUT!!!**

DAILY

- 1) Check for any oil leaks. Keep all hydraulic fittings tight. Check the oil level and temperature in the hydraulic reservoir.
- 2) Check all remote emergency stop button locations. Make sure each emergency stop button is not obstructed, damaged, and working properly. Make sure each emergency stop button is not depressed.
- 3) Check the function of the safety interlock switch.
- 4) Clean around the machine to remove any operator hazards.
- 5) Makes sure all lights, push buttons, decal, and operator instruction are not damaged, functional and visible.

MONTHLY

- 1) Check external hoses for chafing, rubbing, or other deterioration or damage.
- 2) Check for any obvious unsafe conditions in or around the compactor area.
- 3) Check oil level in hydraulic reservoir. Level should be $\frac{3}{4}$ of the sight gauge.
- 4) Check that all safety equipment is in good working order.
- 5) Clean or wash out debris behind the compactor ram.
- 6) Check functional operation of controls and options (stop button, timer, lights, etc.)

THREE MONTHS

- 1) Check hydraulic cylinder(s), internal hoses, and connections for leakage. Check hoses for chafing and wear.
- 2) Lubricate all grease fittings (hydraulic cylinder pins, ratchet binder, container wheels, etc.)

ANNUALLY

- 1) Lubricate electric motor per manufacturer's instructions.

OIL STRAINER

- 1) The oil strainer should be cleaned at regular yearly intervals.
- 2) The filter maybe removed from the unit by disconnecting the union of the suction side of the pump. Remove the four bolts retaining the suction pipe gasket to cover plate and lift the filter from the reservoir.
- 3) Care should be exercised in cleaning the strainer to ensure the element is not torn. Clean the element with a soft brush and industrial solvent.
- 4) Replace and seal the filter after cleaning and tighten the union securely. Pump noise and 'CRACKLE" sound is most often caused by air entering the suction line. Tightening the suction fittings will usually eliminate this problem.

CYLINDER REMOVAL INSTRUCTIONS

DANGER: Only authorized and trained personnel should perform the following procedures. Lock out and tag-out the compactor as specified in the lock-out/tag-out instructions on pages 4 and 5. **DO NOT** enter the compactor for any reason until it has been locked out and tagged out per the Lock-Out/ Tag-Out instructions on pages 4 and 5.

WARNING: RAM SPEED ACCELERATES AS THE RAM RE-TRACTS!! NEVER ENTER ANY PART OF THE COMPACTOR OR CONTAINER UNTIL THE UNIT HAS BEEN LOCKED OUT AND TAGGED-OUT!!!

A STANDARD MEDIUM WEIGHT HYDRAULIC OIL IS RECOMMENDED FOR THIS SYSTEM

CYLINDER REMOVAL INSTRUCTIONS

- 1) Lock-out and tag-out the compactor per the procedure on pages 4 and 5.
- 2) Remove the access covers to the compactor.
- 3) Positively support the ram with a forklift and/or 4" x 4" wooden timbers.

WARNING: Make sure the hydraulic cylinder is securely supported before proceeding.

- 4) Relieve the hydraulic pressure by depressing solenoid valve pin/spool.
- 5) Remove all hydraulic hoses attached to the cylinder.

NOTE: Disconnect one hydraulic hose at a time, removing the hose fitting slowly. Plug ALL ports and hose ends.

- 6) Remove the cylinder pins.
- 7) Remove the cylinder.
- 8) To install the cylinder, reverse the steps.

NOTE: Before reinstalling cylinder, check cylinder pin, and rod for a sign of fatigue. Do not use if wear or cracks are present.

- 9) Fill the reservoir with hydraulic oil to $\frac{3}{4}$ up on the sight gauge.
- 10) Refit all access covers.

NOTE: Covers must be replaced before operating the unit.

Please consult the manual provided in the power unit for further maintenance information. Warning never enter any part of the compactor or container until the unit has been locked-out/tagged-out.

TROUBLESHOOTING

This a general trouble shooting chart. For power unit trouble shooting please refer to the manual provided in each power unit.

DANGER: Only authorized and trained personnel should perform the following procedures. Lock out and tag-out the compactor as specified in the lock-out/tag-out instructions on pages 4 and 5. DO NOT enter the compactor for any reason until it has been locked out and tagged out per the Lock-Out/ Tag-Out instructions on pages 4 and 5.

PROBLEM	SOLUTION
EXCESSIVE VOID IN CONTAINER CHARGE BOX AREA ALAWYS FULL	<ul style="list-style-type: none"> -When loading, throw wastes as far to the rear as possible. -Cycle after each load. Keep door closed. - Cycle unit after each load. -Pack until container FULL light comes on -Loss of hydraulic pressure. Have a qualified technician adjust the hydraulic pressure.
MOTOR WILL NOT OPERATE	<ul style="list-style-type: none"> -Check EMERGENCY STOP BUTTON. -Key in the OFF position. Turn to ON position. -Check security door/gate is shut. -Check container gone limit switch. -Check safety switch is malfunctioning. -Check main breaker. -Check fused disconnect. -Push reset on motor overload. -Refer to power unit manual.
MOTOR RUNS BUT RAM WILL NOT MOVE	<ul style="list-style-type: none"> -Check hydraulic fluid level. -Check motor rotation. -Check directional valve for proper operation. - Check the motor pump connection. -Check for loose/broken fitting or hose. -Check hydraulic cylinders for bypassing. -Refer to power unit manual.
COMPACTOR SHIFTS ERRATICALLY	<ul style="list-style-type: none"> -Check for proper system pressure. -Check for proper pressure switch adjustment. -Check directional valve operation. -Check cylinder pins. -Refer to power unit manual.

TROUBLESHOOTING CONTINUED

PROBLEM	SOLUTION
PRESSURE DECREASES	<ul style="list-style-type: none">-Low oil. Fill to $\frac{3}{4}$ up on sight gauge.-Contaminated fluid. Clean and replace the fluid in the system.-Internal leakage. Inspect and replace any fittings or as needed.-Clean, adjust, or replace the relief valve.-Replace the pump.-Replace the cylinder.
COMPACTOR MAKES EXCESSIVE NOISE	<ul style="list-style-type: none">-Check hydraulic fluid level.-Grease compactor cylinder and ram.-Check for water in hydraulic fluid. Flush and replace hydraulic fluid in entire system.-Check for air in hydraulic system.-Check suction line components for tightness.-Clogged suction strainer. Clean or replace it.

INSTALLATION PAD REQUIREMENTS

CAUTION

Review this manual before making the installation. Study the job site and installation requirements carefully to be certain all necessary safeguards and or safety devices are provided to protect all personnel and equipment during the installation and as a completed system. Special attention is directed to the most current ANSI Z245.2 standard.

These operating instructions are not intended as a substitute for training and experience in proper use and safety procedures and protocols in operating this equipment. International Container Co., LLC does not assume responsibility for the installation procedures of this equipment. Customer is responsible for ensuring compliance with all local, state, and federal laws concerning installation and use.

Warning never enter any part of the compactor or container until the unit has been locked-out/tagged-out.

The VC-100 is designed to be anchored to concrete or asphalt. The concrete or asphalt pad must be level for the VC-100 to function properly.

Concrete Pad

1. Concrete should be minimum 3,000 psi, steel reinforced, 6" thick. It is preferred that the concrete pad be flush with the surrounding ground level.
2. To provide accessibility, concrete pad should be positioned to allow adequate space for the container-handling vehicle. If applicable, allow proper clearances for a through-the-wall chute.

Asphalt Pad

1. If using a steel foundation plate, it should be secured to your pad or floor. If asphalt is used, it should be construction grade material and standard parking lot thickness (approximately 4").
2. To provide accessibility, asphalt pad should be positioned to allow adequate space for the container vehicle. If applicable, allow proper clearances for the through-the-wall chute.

The clearances given are minimums. Your installation may require greater clearances depending on the site and the hauling equipment that will be used.

Decals

Installation of the compactor is not complete until an inspection of warning decals has been made. All warning decals must be in place prior to operating the compactor. Decals should be clearly visible, legible, securely applied, and in the proper location. Refer to the decal placement page. Notify your distributor or International Container Co. if any warning decals are missing or become damaged and need replacing.

INSTALLATION

ANCHORING

Concrete Anchoring

The compactor should be anchored to the concrete pad using (8) minimum 3/4" x 6" long anchor bolts. These bolts can be secured to concrete pad using special concrete anchors. It is best if these holes are drilled in the concrete after pre-locating the compactor in its desired location. When the compactor has been permanently located, shimmed to compensate for unevenness, and anchor bolts set, tighten all nuts securely. Anchor the power unit using 3/8" x 4" long anchor bolts. Allow enough space around the compactor for any maintenance or service (including cylinder removal and liner equipment). Ensure anchor bolts are not allowed to torque or twist the compactor body when tightened.

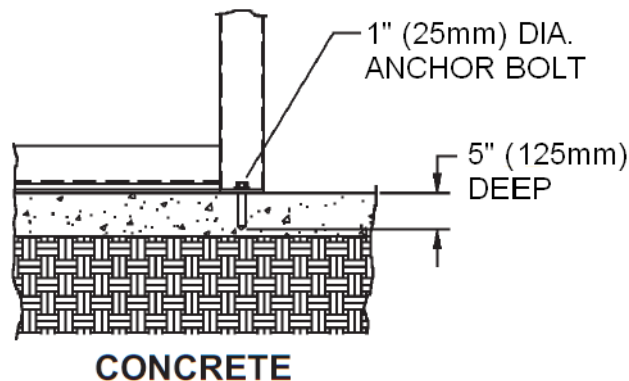

Asphalt Anchoring

For asphalt applications, use eight (8) 7/8" diameter x 36" long pointed steel rods with 1" wrought steel washers welded to the top end. Drive the headed rod through the anchor plate and asphalt and into the ground at each anchor location.

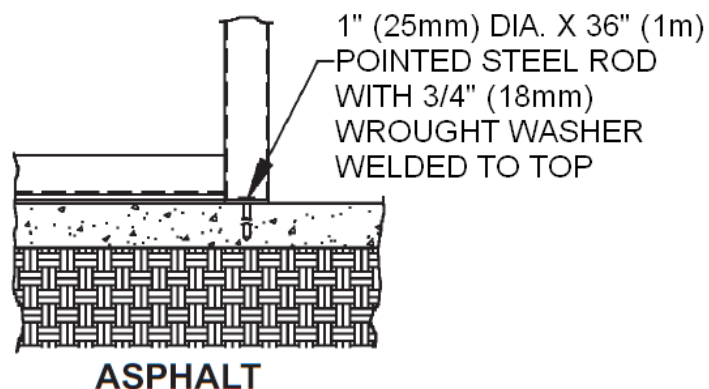

ELECTRICAL INSTALLATION

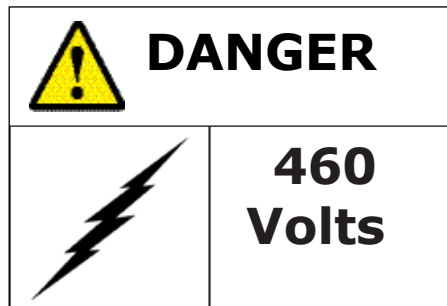

Only authorized personnel should be allowed inside the control panel. The motor control panel contains high voltage components. **DO NOT** enter the compactor for any reason until it has been locked out and tagged out. See Lock-out/Tag-out procedures on pages 4 and 5.

ALL ELECTRICAL INSTALLATION MUST BE PERFORMED BY A LICENSED ELECTRICIAN

In addition to these instructions refer to the power unit manual for installation.

A lockable fused disconnect switch (customer furnished) must be installed and be within sight of the compactor motor control panel location, not to exceed 50'0" from the compactor. This fused disconnect switch should be sized in accordance with the compactor. Refer to power unit manual size chart.

CAUTION: All equipment should be grounded per National Electric Code and all applicable state and local requirements!!!

GROUNDING INSTRUCTIONS: This appliance must be connected to a grounded metal permanent wiring system, or an equipment grounding conductor must be run with the circuit conductors and connected to the equipment grounding terminal or lead on the appliance. If there is any doubt whether the equipment is properly grounded, a qualified electrician should be consulted.

CAUTION: Operator station must be located so that the **EMERGENCY STOP** button is readily accessible to the operator and within three (3) feet of the charging chamber access door. If installation requires the operator station to be in a more remote area, a second **EMERGENCY STOP** button must be added and installed in the manner described above.

ELECTRICAL INSTALLATION CONTINUED

ELECTRICAL CONNECTIONS

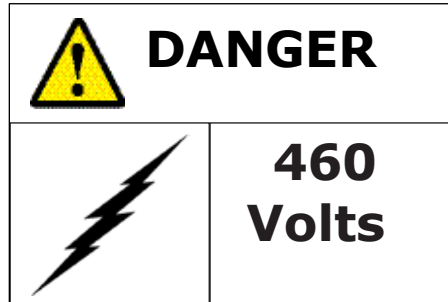

Only authorized personnel should be allowed inside the control panel. The motor control panel contains high voltage components. **DO NOT** enter the compactor for any reason until it has been locked out and tagged out. See Lock-out/Tag-out procedures on pages 4 and 5.

WARNING: Before making any electrical connection, be sure that the disconnect switch has been locked out and tagged out.

DANGER: All equipment should be grounded per National Electric Code.

WARNING: POWER UNIT MUST BE WIRED CORRECTLY FOR SUPPLY VOLTAGE!!!

- 1) Before connecting power to the compactor, check the incoming voltage with a voltmeter. Also, check voltage on the compactors panel box. If the compactor is not wired to proper voltage, make necessary corrections before proceeding.
- 2) A lockable fused disconnect switch (customer furnished) must be installed and be within sight of the compactor's panel box location, not to exceed 50' from the compactor.

NOTE: A fused disconnect switch should be sized in accordance with the compactor.

NOTE: A properly sized ground should be attached to the enclosure ground terminal.

- 3) Run power lines between fused disconnect switch (customer furnished) and the compactor's electrical panel, in accordance with local electrical codes, using knockouts in the bottom of the panel box.
- 4) Check the voltage at the fused disconnect switch to be certain it is the same as is shown on the compactor power pack.

ELECTRICAL INSTALLATION CONTINUED

PUSH BUTTON CONTROL PENDANT

Only authorized personnel should be allowed inside the control panel. The motor control panel contains high voltage components. DO NOT enter the compactor for any reason until it has been locked out and tagged out. See Lock-out/Tag-out procedures on pages 4 and 5.

A remote operator station is furnished with all power units and is factory wired with sealtite conduit. If it is necessary to disconnect it from the wires (to install the operator station inside the building) exercise care that the wires are reconnected as originally furnished by the factory.

NOTE: Check local codes to be certain sealtite is acceptable.

CAUTION: The operator station must be located so that the **EMERGENCY STOP** button is readily accessible to the operator and within three (3) feet of the charging chamber access door. If the installation requires this operator station to be in a more remote area, a second **EMERGENCY STOP** button must be installed within three (3) feet of the access door.

HYDRAULIC INSTALLATION

Only authorized personnel should be allowed inside the control panel. The motor control panel contains high voltage components. DO NOT enter the compactor for any reason until it has been locked out and tagged out. See Lock-out/Tag-out procedures on pages 4 and 5.

NOTE: The power unit is internally installed at the factory. The hydraulic pressure is also set at the factory. All hoses are installed at the factory.

- 1) Check hydraulic hose connections. The **A** port from the solenoid valve attaches to the base (extend) port of the hydraulic cylinder. The **B** from the solenoid valve attaches to the front (retract) port of the hydraulic cylinder.
- 2) Fill the hydraulic reservoir with hydraulic oil until it is at $\frac{3}{4}$ up in the sight gauge.

NOTE: After start up it may be necessary to add more hydraulic oil to the reservoir. Maintain the oil level to $\frac{3}{4}$ up the sight gauge with the cylinder in the fully retracted (up) position.

INSTALLATION START UP INSTRUCTIONS

Only authorized personnel should be allowed inside the control panel. The motor control panel contains high voltage components. DO NOT enter the compactor for any reason until it has been locked out and tagged out. See Lock-out/Tag-out procedures on pages 4 and 5.

WARNING: IN CASE OF EMERGENCY PUSH THE LARGE RED BUTTON!!

- 1) Check and make sure that all electrical and hydraulic connections have been made correctly.
- 2) Make sure the container is positioned all the way under the VC-100 head and the feed door is closed.

NOTE: Check the door open and close function. If the door binds against the top or bottom the unit is not level.

Unit must be level for proper operation.

- 3) With the ram fully retracted (UP position), make sure the oil reservoir is full to $\frac{3}{4}$ level on sight gauge.

NOTE: The hydraulic pressure is also set at the factory and the entire unit is tested at the factory.

CAUTION: Make sure all persons and material are clear of charge box area and all other areas of the compactor.

- 4) Turn the disconnect switch to the **ON** position when ready to start the machine.
- 5) Make sure the **EMERGENCY STOP** button is not depressed.
- 6) Make sure the feed door is closed and locked.
- 7) Turn the key to the **ON** position. Then turn the key switch to the **START** position.
- 8) The ram should fully retract and allow the door to open. This should only take a couple of seconds.

WARNING: If the ram does not move immediately depress the EMERGENCY STOP button!!! The pump will be damaged if it is operated in the wrong direction even for short periods. Reversing any two incoming power lines will change the pump/motor rotation.

- 9) Check the functions of all interlock safety switch and **EMERGENCY STOP** button.
- 10) Run the VC-100 for a few cycles to make sure it is operating properly.

NOTE: If the ram scrubs the side of the charge box the unit is not level.

Unit must be level for proper operation.

- 11) Make sure that ALL REQUIRED operators are trained in proper use of this equipment.

HAULER INFORMATION

FRONT LOAD

NOTE: Front load, front feed VC-100 shown. The feed door will only be visible in a front load/front feed scenario.

CAUTION: Stand clear when the container is being lifted!!

- 1) Make sure the green driver's light is illuminated. The green light must be on to remove the container. This light indicates the compactor ram is not inside the container preventing the removal of the container.

WARNING: If the ram is inside the container while trying to remove the container from the stand, significant damage will occur!

- 2) Remove and empty the container.

NOTE: If the container does not have casters, you must raise the container slightly to remove it.

- 3) Insert the container completely back under the compactor head.

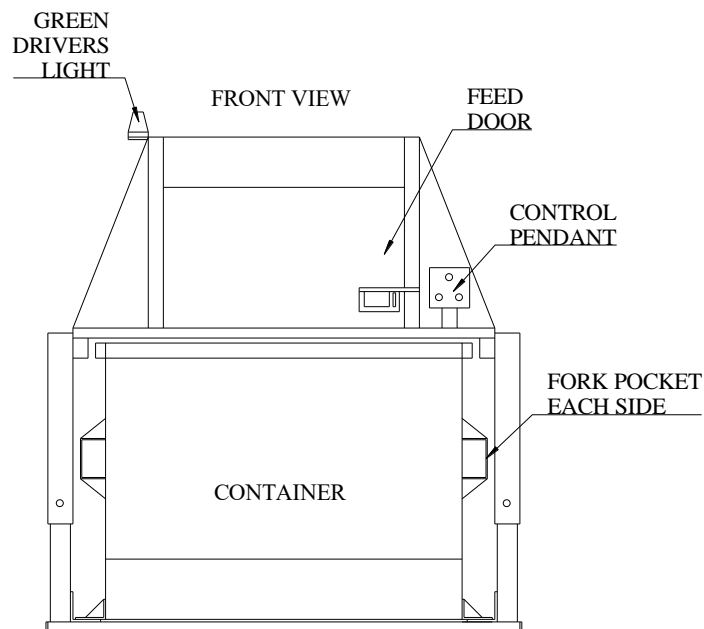

LEGAL PROVISIONS

Limitation on Liability

1. TO THE MAXIMUM EXTENT PERMITTED BY APPLICABLE LAW, THE RIGHTS AND REMEDIES SET FORTH HEREIN (WHETHER BY WAY OF DAMAGES, PAYMENT OR REIMBURSEMENT OF COSTS, PRICE REDUCTION, MAKE GOOD OR REMEDIATION, TERMINATION OR OTHERWISE) SHALL BE ITS SOLE AND EXCLUSIVE RIGHTS AND REMEDIES REGARDLESS OF THE EVENTS, CIRCUMSTANCES OR THEORY ON WHICH A CLAIM MAY BE BASED (INCLUDING TERMINATION, BREACH OF CONTRACT OR STATUTORY DUTY, NEGLIGENCE OR OTHER TORT, STRICT LIABILITY, INDEMNITY, RESCISSION / WITHDRAWAL OR OTHERWISE).

2. Notwithstanding any other provision to the contrary or the failure of the essential purpose of any exclusive or limited remedy, except only to the extent the exclusion of International Container Company's liability is limited by applicable law (in which circumstances International Container Company's liability shall be limited to the greatest extent permitted by applicable law):

INTERNATIONAL CONTAINER COMPANY SHALL IN NO CASE WHATSOEVER BE LIABLE FOR ANY (A) LOSS OF REVENUES OR PROFITS; LOSS OF OPPORTUNITY, PRODUCTION OR CONTRACTS; LOSS OF USE; STANDBY COSTS; LOSS OF OR DAMAGE TO UTILITIES OR PRODUCT; PLANT DOWNTIME OR DELAYS; LOSS OF GOODWILL; LIQUIDATED DAMAGES OR PENALTIES; CONTRACTUAL LIABILITY TOWARDS ANY THIRD PARTY; COSTS TO RECALL THE PRODUCT; ANY DAMAGES FINES OR PENALTIES; OR OTHERWISE FOR ANY FINANCIAL OR ECONOMIC LOSSES OR DAMAGES, AND IN EACH CASE IRRESPECTIVE WHETHER THE LOSSES OR DAMAGES IN QUESTION ARE DEEMED OR CLAIMED TO BE DIRECT, CONSEQUENTIAL, INDIRECT OR OTHERWISE, OR (B) FOR ANY CONSEQUENTIAL, INDIRECT, SPECIAL, INCIDENTAL, PUNITIVE OR EXEMPLARY, LOSSES OR DAMAGES HOWSOEVER CAUSED OR ARISING; OR (C) FOR ANY LOSS OR DAMAGE TO THE EXTENT ARISING OUT OF THE SOLE OR CONTRIBUTORY NEGLIGENCE OF YOU, YOUR EMPLOYEES OR AGENTS OR ANY THIRD PARTY.

3. Notwithstanding any other provision to the contrary or the failure of the essential purpose of any exclusive or limited remedy, except only to the extent the exclusion or limitation of International Container Company's liability is prohibited by applicable law (in which circumstances International Container Company's liability shall be limited to the greatest extent permitted by applicable law):

INTERNATIONAL CONTAINER COMPANY'S MAXIMUM AGGREGATE LIABILITY TO YOU OR ANYONE OPERATING THE [VC-100] SHALL IN NO CASE EXCEED THE GREATER OF THE PRICE PAID FOR OR REMAINING FAIR MARKET VALUE OF THE [VC-100], IRRESPECTIVE WHETHER SUCH LIABILITY ARISES BY WAY OF BREACH OF CONTRACT OR OF STATUTORY DUTY, NEGLIGENCE OR OTHER TORT, STRICT LIABILITY, INDEMNITY, CONTRACT PRICE REDUCTION OR REPAYMENT, TERMINATION, RESCISSION/WITHDRAWAL, MAKE GOOD OR REMEDIATION OR OTHERWISE.

4. No provision herein shall be deemed to expand or extend any provision of any other written document provided by International Container Company. Use of the [VC-100] is done at your sole risk and all procedures and policies shall be strictly followed. To the extent any waiver or disclaimer contained herein is deemed unlawful or unenforceable under applicable law, such waiver or disclaimer shall be deemed to be removed herefrom but only to such extent necessary to make such waiver or disclaimer compliant with applicable law.

Warranties; Disclaimers

1. International Container Company only provides the warranty set forth in its separate warranty policy and no other warranty. TO THE FULLEST EXTENT PERMITTED BY LAW, INTERNATIONAL CONTAINER COMPANY DISCLAIMS ALL REPRESENTATIONS AND WARRANTIES OF ANY KIND, WHETHER EXPRESS, IMPLIED OR STATUTORY, INCLUDING, BUT NOT LIMITED TO, THE IMPLIED WARRANTIES OF TITLE,

QUALITY, PERFORMANCE, MERCHANTABILITY, SUITABILITY, FITNESS FOR A PARTICULAR PURPOSE, ACCURACY AND NON-INFRINGEMENT RELATED TO OR ARISING FROM THE [VC-100 VERTICAL COMPACTOR], AS WELL AS WARRANTIES IMPLIED FROM ANY ALLEGED COURSE OF DEALING OR COURSE OF PERFORMANCE. INTERNATIONAL CONTAINER COMPANY DOES NOT WARRANT THAT THE VC-100 VERTICAL COMPACTOR WILL PROVIDE CONTINUOUS, PROMPT, SECURE, OR ERROR-FREE SERVICE. INTERNATIONAL CONTAINER COMPANY ASSUMES NO LIABILITY FOR ANY ERRORS OR OMISSIONS, INCLUDING THE INACCURACY OF CONTENT, OR FOR ANY DAMAGES OR LOSSES THAT YOU OR ANY THIRD-PARTY MAY INCUR AS A RESULT OF THE UNAVAILABILITY OR FAILURE OF [VC-100 VERTICAL COMPACTOR].

2. International Container Company's responsibility under any warranty is subject to the condition that the underlying defect is not caused by one or more of the following: (i) use of non-original spare parts; (ii) use not in strict conformity with the specifications stated in International Container Company's written manuals and materials; (iii) any failure of upstream and/or downstream equipment necessary for the product to function properly; (iv) modifications without International Container Company's express prior written consent; (v) use of corrosive or abrasive substances; or (vi) the storage, handling, use, operation or maintenance of the product which is not in strict conformity with good engineering practice and any written requirements of International Container Company's written manuals and materials.

3. Any remedies set forth in the warranty policy shall be the sole and exclusive remedies in respect of any warranty obligation and International Container Company shall not be liable for any loss or damage caused by or resulting from any breach of warranty. If it is ultimately determined that this remedy fails of its essential purpose, then International Container Company's maximum liability is limited to the [VC-100].

4. The expiration of any applicable warranty period shall, to the maximum extent permitted by applicable law, constitute conclusive evidence for all purposes and in all proceedings whatsoever between the parties that International Container Company has completed its obligations under or arising out of the warranty offered by International Container Company. After the expiration of any applicable warranty period, all claims of any nature whatsoever that may exist against International Container Company, whether known or not, under or arising out of the applicable warranty, and any right, cause of action and or remedy shall be deemed to be barred and extinguished.

Forum Selection Clause

1. The exclusive jurisdiction and the exclusive venue of the resolution of any dispute arising from the provisions of this Manual or use of the [VC-100 VERTICAL COMPACTOR] shall lie with the Superior Court of Massachusetts, Hampden County.